

# BOUNDED SEAL

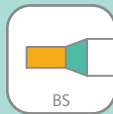

# BONDED SEAL BS SERIES

- Reliable high and low pressure sealing.
- Wide temperature capability.
- Over compression prevented by metal outer ring.
- Wide range of metals and elastomers.
- Available in a wide range of imperial and metric sizes

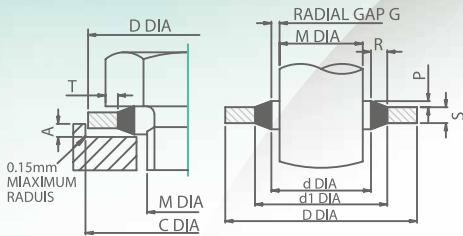

MATERIAL(Rubber)	NBR	FKM
MATERIAL (Metal)	Carbon Steel	Carbon Steel
Hardness (Shore A)	70	70
Color	Black	Brown
Temperature Range (°C )	-30 to 100	-20 to 200

## BRITISH IMPERIAL

BS SIZE	THREAD DIA "M"		d	d1	D	S	R	P	RADIAL GAP G+0.07	
	INCH	B.S.P.							INCH	B.S.P.
BS-001	6BA		3.05	3.50	6.35	1.20	0.54	0.2/0.38	0.13	
BS-002	4BA		4.12	5.26	7.26		0.57		0.26	
BS-003	2BA		5.21	6.35	8.35		0.57		0.26	
BS-004	1/4		6.86	8.00	13.21		1.27		0.32	
BS-005	1/4		6.99	9.53	13.34		0.56		0.19	
BS-006	5/16		8.31	9.53	13.34		0.70		0.35	
BS-007	5/16		8.64	10.04	14.22		0.60		0.05	
BS-008	40		11.26	12.45	18.36	2.00	0.70	0.29		
BS-009	7/16		11.69	13.08	19.05		0.76	0.29		
BS-010	9/16		14.86	16.39	22.23		1.12	0.32		
BS-011	5/8		16.51	18.75	25.40		3.20	0.89	0.23	
BS-013	15/16		24.26	26.04	33.27			0.76	0.38	
BS-014	1+1/8		29.33	30.86	36.58			1.52	0.45	
BS-015	1+1/4		32.64	35.69	41.40			1.52	0.51	
BS-016	1+3/8		35.94	38.99	44.45	1.54		0.43		
BS-017	1+1/2		38.96	42.04	47.75	1.52		0.45		
BS-018	1+3/4		45.34	48.39	57.15			0.45		
BS-019	2		51.69	54.74	63.50	2.00	0.73	0.42		
BS-020	3/8		10.37	11.84	15.88		0.73	0.52	0.29	
BS-021	1/2	1/4	13.74	15.21	20.57		0.73	0.30		
BS-022	60		15.83	17.30	22.23		2.30	0.76		0.31
BS-023		3/8	17.28	18.75	23.80			0.76	0.32	
BS-024	3/4		19.69	21.21	26.92			0.73	0.45	0.29
BS-025	13/16	1/2	21.54	23.01	28.58			2.30	0.74	0.63
BS-026	7/8	5/8	23.49	24.97	31.75	0.74			0.82	0.30
BS-027	1	3/4	27.05	28.53	34.93	1.40			0.41	
BS-028	1+1/16		27.82	30.61	38.61	3.20		0.74	0.33	0.30
BS-029	1+3/16	7/8	30.81	32.29	38.10		1.50	0.28	0.40	
BS-030	1+5/16	1	33.89	36.88	42.80		1.50	0.28	0.40	
BS-031	1+5/16	1	33.89	36.88	42.80		1.50	0.82	0.51	
BS-032	1+5/8	1+1/4	42.93	45.93	52.38		3.20	1.47	0.40	0.32
BS-033	1+7/8	1+1/2	48.44	51.39	58.60			1.70	0.45	0.57
BS-034	2+1/8		54.89	58.30	69.85			1.52	0.45	
BS-035	2+1/4		58.04	61.09	70.36	1.52				0.48
BS-036		2	60.58	63.63	73.03	1.52		0.45		
BS-037	2+1/2		64.39	67.44	77.22	1.65				
BS-038		2+1/4	66.68	69.98	79.50	1.65			0.59	
BS-039		2+1/2	76.08	79.38	90.17	1.65		0.45		

# GERMAN METRIC RANGE

BS SIZE	THREAD DIA "M"	d	d1	D	S	R	P	RADIAL GAP"G"
BS-201	3.5	4.10	5.20	7.20	1.00	0.55	0.30	0.30
BS-202	4	4.50	5.40	7.00		0.45		0.25
BS-203	5	5.70	6.80	9.00		0.65		0.35
BS-204	5	5.70	7.40	10.00		0.85		
BS-205	5.5	5.70	7.20	9.20	2.50	0.50	0.30	
BS-206	6	6.70	8.00	10.00		0.65		
BS-207	6	6.70	8.20	11.00	1.00	0.75	0.30	
BS-208	6	6.70	8.20	11.00		0.75		
BS-209	6.5	7.10	8.80	12.00	1.00	0.85	0.30	
BS-210	6.7	7.30	8.60	10.20		0.65		
BS-211	8	8.50	9.40	13.40	1.00	0.45	0.25	
BS-212	8	8.70	10.00	13.00		0.65		
BS-213	8	8.70	10.40	14.00	2.00	0.85	0.35	
BS-214	8	8.70	10.40	16.00		0.60		
BS-215	8.5	9.30	10.50	13.30	1.50	0.82	0.40	
BS-216	10	10.35	12.00	16.00		0.85		
BS-217	10	10.70	12.40	16.00	1.50	0.85	0.35	
BS-218	10	10.70	12.40	18.00		0.65		
BS-219	11	11.40	12.70	16.30	1.50	0.95	0.40	
BS-220	11	11.80	13.70	18.50		0.85		
BS-221	11	11.80	13.50	19.10	1.50	0.85	0.4	
BS-222	12	12.70	14.40	18.00				0.4
BS-223	12	12.70	14.40	20.00	1.50	0.85	0.35	
BS-224	13	13.70	15.40	20.00				1.50
BS-225	13	13.70	15.40	22.00	1.50	0.85	0.35	
BS-226	13.5	14.00	15.70	18.70				1.50
BS-227	14	14.70	16.40	22.00	1.50	0.89	0.50	
BS-228	15	16.00	17.78	22.70				1.50
BS-229	16	16.70	18.40	24.00	1.50	0.90	0.20	
BS-230	17	17.40	19.20	24.00				1.50
BS-231	17.5	18.00	20.10	24.70	1.50	0.85	0.35	
BS-232	18	18.70	20.40	26.00				1.50
BS-233	20	20.70	22.50	28.00	2.50	0.90	0.40	
BS-234	21	21.50	23.30	28.70				1.50
BS-235	22	22.50	24.20	28.00	2.00	0.85	0.35	
BS-236	22	22.70	24.40	30.00				3.00
BS-237	22	22.70	24.40	30.00	2.00	0.85	0.35	
BS-238	24	24.70	26.40	32.00				2.00
BS-240	27	27.20	29.00	36.00	2.00	0.90	0.10	
BS-241	28	28.70	30.40	37.00				2.00
BS-242	30	31.00	33.00	39.00	2.00	1.00	0.50	
BS-243	33	33.70	35.80	42.00				2.00
BS-244	33	34.30	36.40	43.00	2.00	1.05	0.65	
BS-245	36	36.70	38.80	46.00				2.50
BS-246	39	40.00	41.90	51.00	2.50	0.95	0.50	
BS-247	42	42.70	44.40	53.00				3.00
BS-248	48	48.70	50.80	59.00	3.00	1.05	0.35	
BS-249	51	52.00	54.10	60.00				3.00
BS-250	52	53.30	56.40	64.50	3.00	1.15	0.50	
BS-251	60	60.70	63.00	73.00				3.50
BS-252	68	68.60	72.10	79.50	3.50	1.51	0.35	
BS-253	75	76.08	79.10	90.30				3.50
BS-254	88	89.09	92.10	101.48	3.20	1.50	0.54	

# BS SERIES

BS-03

www.ovux.ru

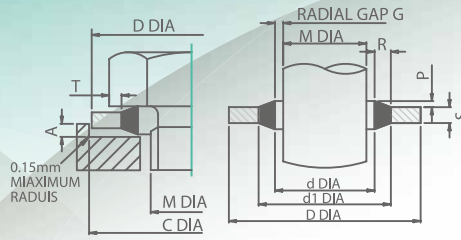

## FRENCH METRIC RANGE

BS SIZE	THREAD DIA "M"	d	d1	D	S	R	P	RADIAL GAP"G"		
BS-301	3	3.60	5.00	7.50	1.00	0.70		0.30		
BS-302	4	4.60	6.00	9.00						
BS-303	5	5.60	7.00	10.00						
BS-304	6	6.60	8.00	11.00						
BS-305	6	6.85	8.00	13.27	1.30	0.57	0.30	0.42		
BS-306	6	7.00	8.40	11.40	1.00	0.70		0.50		
BS-307	8	8.60	10.00	13.00					0.30	
BS-310	10	10.70	12.10	17.00					0.35	
BS-312	11	11.80	13.20	18.10	1.50	0.65		0.40		
BS-313	12	12.70	14.10	19.00				0.35		
BS-315	13	13.80	15.20	20.10			0.70	0.40	0.40	
BS-316	14	14.70	16.10	21.00						
BS-317	16	16.70	18.10	23.00	2.0	0.75	0.40	0.35		
BS-319	16.5	17.20	18.70	23.90						
BS-320	18	18.70	20.40	27.00						
BS-321	20	20.70	22.40	29.00						
BS-324	22	22.70	24.40	31.00	2.0	0.85	0.40	0.35		
BS-325	23	23.70	25.40	32.00						
BS-326	24	24.70	26.40	33.00						
BS-327	26	27.00	28.70	35.30						
BS-328	27	27.70	29.40	36.00	2.00	0.85	0.40	0.50		
BS-329	28	28.60	30.30	36.00						0.35
BS-330	28.5	29.20	30.90	37.50						0.30
BS-331	30	30.70	32.40	39.00						0.35
BS-332	33	33.70	35.40	42.00	2.50	1.30		0.50		
BS-333	36	37.00	39.60	48.00						
BS-334	39	40.00	42.00	51.00						
BS-335	42	43.00	45.60	54.00						
BS-336	45	46.00	48.60	57.00						
BS-337	48	49.00	51.60	60.00						

## BONDED SEALS TO SUIT PIPE CONNECTIONS AND COUPLINGS

BS SIZE	THREAD DIA "M"	d	d1	D	S	R	P
BS-510	1/8	10.40	12.00	14.70	1.20	0.80	0.25
BS-511	1/4	13.85	15.75	18.70			
BS-512	3/8	17.35	19.25	22.70			
BS-513	1/2	21.65	23.55	26.70			
BS-514	3/4	27.30	29.20	32.50	2.00	0.95	
BS-515	1	34.20	36.10	39.50			
BS-516	1 1/4	42.80	44.70	49.50			
BS-517	1 1/2	48.70	50.60	55.50			
BS-518	2	60.50	62.40	68.50	1.20		
BS-519	1/16	8.30	9.90	12.70			
BS-520		27.30	29.20	32.60			

# BONDED SEAL SCR SERIES (Self Centering Rang)

- Reliable high and low pressure sealing.
- Wide temperature capability.
- Over compression prevented by metal outer ring.
- Wide range of metals and elastomers.
- Available in a wide range of imperial and metric sizes

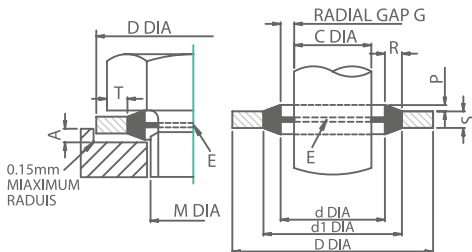

MATERIAL(Rubber)	NBR	FKM
MATERIAL (Metal)	Carbon Steel	Carbon Steel
Hardness (Shore A)	70	70
Color	Black	Brown
Temperature Range (°C )	-30 to 100	-20 to 200

SCR SIZE	THREAD DIA "M"	C	d	d1	D	S	P	E
SCR-007	5/16	7.24	8.64	10.04	14.22	1.20	0.20	0.35
SCR-011	5/8	12.90	16.51	18.75	25.40	2.00	0.20	
SCR-012	11/16	14.50	18.16	19.69	25.40	2.50	0.25	
SCR-017	1+1/2	34.76	38.96	42.04	47.75	3.20	0.25	
SCR-020	1/8 BSP	8.26	10.37	11.84	15.88	2.00	0.20	
SCR-021	1/4 BSP	11.18	13.74	15.21	20.57			
SCR-023	3/8 BSP	14.96	17.28	18.75	23.80	2.50	0.25	
SCR-025	1/2 BSP	18.64	21.54	23.01	28.58			
SCR-026	5/8 BSP	20.27	23.49	24.97	31.75			
SCR-027	3/4 BSP	24.13	27.05	28.53	34.93			
SCR-029	7/8 BSP	27.51	30.81	32.29	38.10			
SCR-030	1 BSP	29.92	33.89	36.88	42.80			
SCR-032	1 1/4 BSP	38.45	42.93	45.93	52.38			
SCR-033	1 1/2 BSP	44.45	48.44	51.39	58.60			
SCR-034	1 3/4 BSP	50.42	54.89	58.30	69.85			
SCR-036	2 BSP	56.26	60.58	63.63	73.03			
SCR-038	2 1/4 BSP	62.36	66.68	69.98	79.50			
SCR-039	2 1/2 BSP	71.50	76.08	79.38	90.17			
SCR-202	M4	3.40	4.50	5.40	7.00	1.00	0.30	
SCR-203	M5	4.50	5.70	6.80	9.00		0.40	
SCR-206	M6	4.70	6.70	8.00	10.00		0.30	
SCR-207	M6	4.70	6.70	8.20	11.00			
SCR-212	M8	6.40	8.70	10.00	13.00	1.50	0.40	
SCR-213	M8	6.40	8.70	10.40	14.00			
SCR-217	M10	8.05	10.70	12.40	16.00	1.50	0.38	
SCR-222	M12	9.50	12.70	14.40	18.00			
SCR-223	M12	10.12	12.70	14.40	20.00	1.50	0.40	
SCR-225	M13	10.00	13.70	15.30	22.00			
SCR-226	M13.5	11.80	14.00	15.70	18.70			
SCR-227	M14	11.38	14.70	16.40	22.00			
SCR-229	M16	13.41	16.70	18.40	24.00			
SCR-230	M17	14.90	17.40	19.20	24.00			
SCR-232	M18	14.76	18.70	20.40	26.00			
SCR-233	M20	16.76	20.70	22.50	28.00			
SCR-236	M22	18.74	22.70	24.40	30.00			
SCR-238	M24	20.11	24.70	26.40	32.00			
SCR-239	M26	22.80	26.70	28.40	35.00			
SCR-245	M36	31.80	36.70	38.80	46.00			
SCR-254	M88	84.50	89.09	92.10	101.35	3.25	0.35	
SCR-303	M5	4.40	5.60	7.00	10.00	1.00	0.30	0.35
SCR-304	M6	4.70	6.60	8.00	11.00	1.00	0.30	
SCR-307	M8	6.30	8.60	10.20	13.00		0.50	
SCR-313	M12	9.73	12.70	14.10	19.00	1.50	0.30	
SCR-328	M27	23.30	27.70	29.40	36.00	2.00	0.40	